

Schalenkern SK 22 x 13
Pot core SK 22 x 13

Magn. Formkenngrößen/Satz
eff. magn. parameters/set

Formfaktor <i>core factor</i>	$C_1 =$	0,48 mm ⁻¹
Eff. magn. Weglänge <i>eff. magn. path length</i>	$l_e =$	31,2 mm
Eff. magn. Querschnitt <i>eff. magn. cross section</i>	$A_e =$	64,8 mm ²
Eff. magn. Volumen <i>eff. magn. volume</i>	$V_e =$	2020 mm ³
Gewicht <i>weight</i>	$G \approx$	14 g

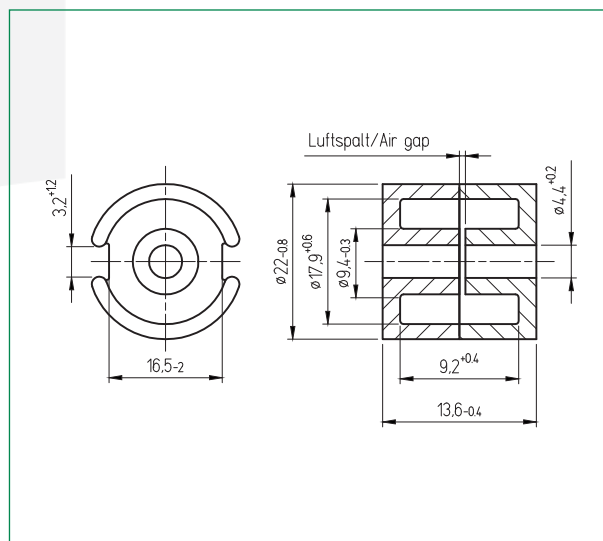

Werkstoff <i>material</i>	A_L -Wert A_L value nH	Toleranz <i>tolerance</i>	Luftspalt <i>airgap</i> mm	μ_e	Bestellnummer <i>order number</i>
K 2005	3850	± 25%	-	≈ 1530	326 220000 025
K 2006	3800	± 25%	-	≈ 1500	326 220000 026
K 4000	6400	± 25%	-	≈ 2550	326 220000 004
K 6000	9000	± 30%	-	≈ 3580	326 220000 006
K 2005	630	± 5%	≈ 0,10	≈ 250	326 220630 025
K 2005	400	± 3%	≈ 0,16	≈ 160	326 220400 025
K 2005	250	± 3%	≈ 0,28	≈ 100	326 220250 025

All information given without liability. If you require further information about our products, do not hesitate to contact our representatives, or visit our homepage, www.kaschke.de.

Kaschke Components GmbH

Rudolf-Winkel-Straße 6 · 37079 Göttingen · Germany
 Fon +49 (0) 551-5058-6 · Fax +49 (0) 551-65756
 kaschke.de